

MAGNITECH POST TOP RANGE



OVERVIEW



The POSTLED range displays a modern and fresh design which compliments any landscape. The marine grade aluminium housing ensures longevity of the fixture whilst providing a visual elegance. All the fittings within the POSTLED range deliver a >70 000hr life span and are available in both symmetrical and asymmetrical light distributions.



APPLICATIONS

- PUBLIC AMENITY LIGHTING
- OUTDOOR LIGHTING
- OFFICE PARKS
- WALK WAYS



ENERGY EFFICIENT LED



MAGNITECH
LIGHTING INDUSTRIES

MAGNITECH - BENCHMARKING
THE STANDARD OF **QUALITY**

LIBRA

IES ROAD REPORT
PHOTOMETRIC FILENAME : JD-1044A-60W.IES
POLAR GRAPH

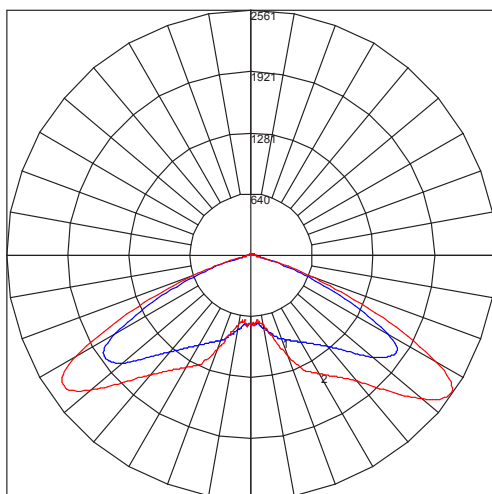

Maximum Candela = 2561,161 Located At Horizontal Angle = 115, Vertical Angle = 54.5
1 - Vertical Plane Through Horizontal Angles (0 - 180)
2 - Vertical Plane Through Horizontal Angles (90 - 270)

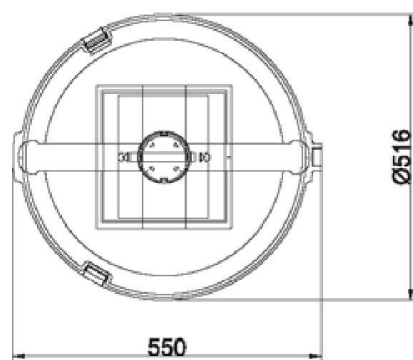
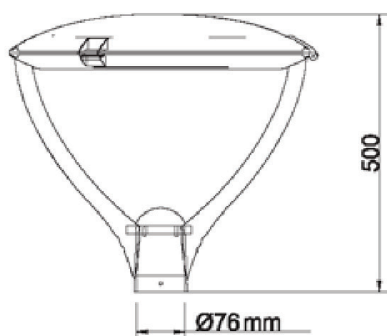

FEATURES AND ORDERING DATA

Item Number	PLED3044	PLED6044	PLED1044
Light Source	LED		
Input Voltage Frequency	AC 100 - 277V / 50 - 60 Hz		
Power Factor	> 0.95		
Power Consumption	30W	60W	100W
LED Pcs	24	48	64
Luminous Flux	2700Lm / 4000K	5400Lm / 4000K	9000Lm / 4000K
Colour Temperature	4000K / 5000K / 6000K		
Colour Rendering Index	Ra > 75		
Light Distribution	Symmetrical and Asymmetrical		
Operating Temperature	- 40 °C ~ 45 °C		
Operating Humidity	20% ~ 90% HD		
Lifetime Residual Flux	L70 @ 70 000 Hrs		
Housing	ADC 12 Marine Grade Aluminium		
IP Rating	IP66		
Dimensions	550 x 516 x 500 mm		
Electrical Class	Class 1		
Surge Arrestor	10kv / 20kv		

TAURUS

IES ROAD REPORT
PHOTOMETRIC FILENAME : JD-1054B-60W.IES
POLAR GRAPH

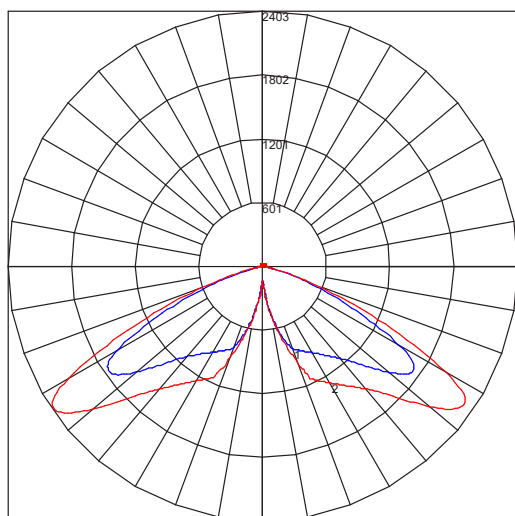

Maximum Candela = 2402.57 Located At Horizontal Angle = 290, Vertical Angle = 55
1 - Vertical Plane Through Horizontal Angles (0 - 180)
2 - Vertical Plane Through Horizontal Angles (90 - 270)



Dimension

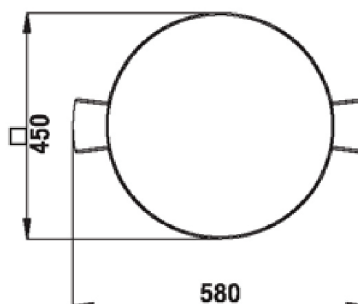
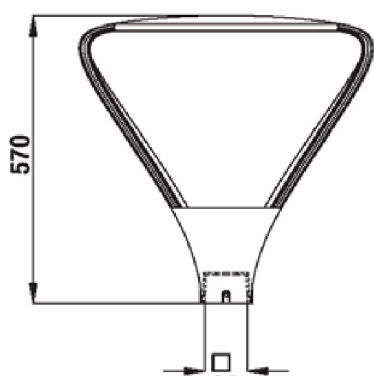

FEATURES AND ORDERING DATA

Item Number	PLED3004	PLED6004
Light Source	LED	
Input Voltage Frequency	AC 100 277 V / 50 - 60 Hz	
Power Factor	> 0.95	
Power Consumption	30W	60W
LED Pcs	Cree LED	
Luminous Flux	2700 Lm / 4000K	5400 Lm / 4000K
Colour Temperature	4000K / 5000K / 6000K	
Colour Rendering Index	Ra > 75	
Light Distribution	Symmetrical and Asymmetrical	
Operating Temperature	- 40 °C ~ 45 °C	
Operating Humidity	20% ~ 90% HD	
Lifetime Residual Flux	L ₇₀ @ 70 000 Hrs	
Housing	ADC 12 Marine Grade Aluminium	
IP Rating	IP66	
Dimensions	580 x 450 x 570 mm	
Class	Class 1	
Surge Arrestor	10kv / 20kv	

PISCES

IES ROAD REPORT
PHOTOMETRIC FILENAME : JD-1057B-60W.IES
POLAR GRAPH

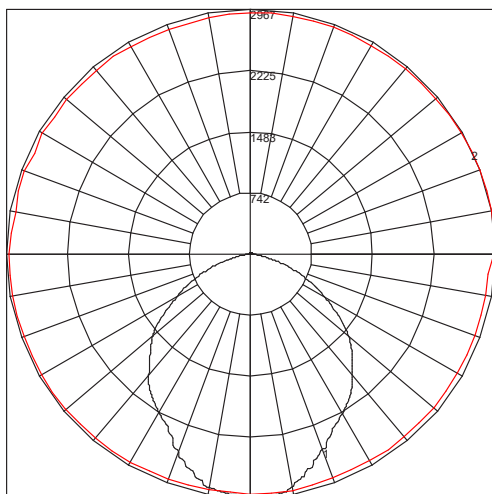

Maximum Candela = 2966.551 Located At Horizontal Angle = 10, Vertical Angle = 2
1 - Vertical Plane Through Horizontal Angles (0 - 180)
2 - Horizontal Cone Through Vertical Angle (2) (Through Max. Cd.)

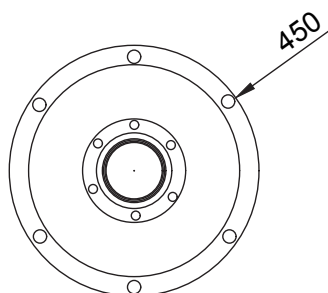
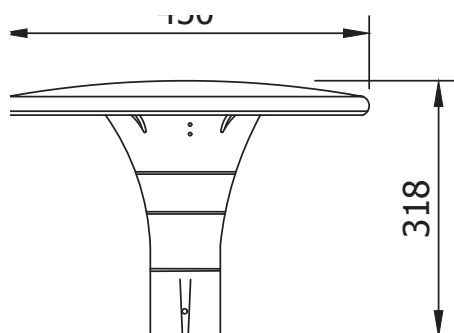

FEATURES AND ORDERING DATA

Item Number	PLED3007	PLED6007	PLED1007
Light Source	LED		
Input Voltage Frequency	AC 100 - 277V / 50 - 60 Hz		
Power Factor	> 0.95		
Power Consumption	30W	60W	100W
LED Pcs	48	108	192
Luminous Flux	100Lm / W	100Lm / W	100Lm / W
Colour Temperature	4000K / 5000K / 6000K		
Colour Rendering Index	Ra > 75		
Light Distribution	Symmetrical and Asymmetrical		
Operating Temperature	- 40 °C ~ 45 °C		
Operating Humidity	20% ~ 90% HD		
Lifetime Residual Flux	L70 @ 70 000 Hrs		
Housing	ADC 12 Marine Grade Aluminium		
IP Rating	IP66		
Dimensions	450 x 450 x 318 mm		
Electrical Class	Class 1		
Surge Arrestor Options	10kv / 20kv		

OPERA

IES ROAD REPORT
PHOTOMETRIC FILENAME : OPERA - 65W.IES
POLAR GRAPH

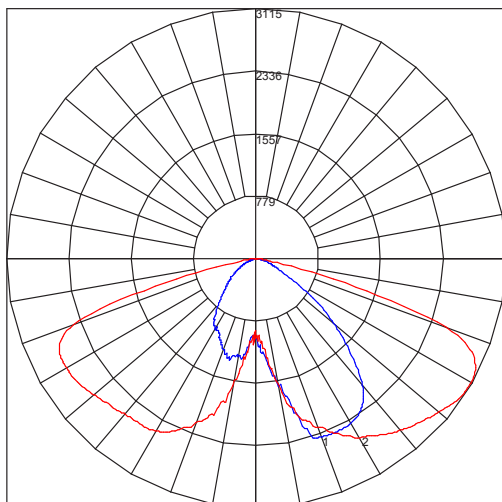

Maximum Candela = 3114.6 Located At Horizontal Angle = 80, Vertical Angle = 60
1 - Vertical Plane Through Horizontal Angles (0 - 180)
2 - Vertical Plane Through Horizontal Angles (90 - 270)

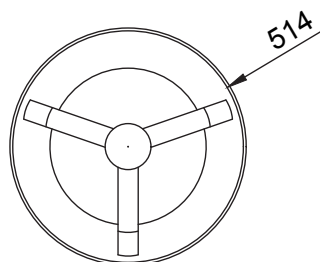
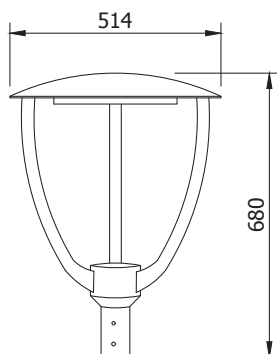

FEATURES AND ORDERING DATA

Item Number	PT00018	PT00025	PT00035	PT00045	PT00065
Power Consumption	18W	25W	35W	45W	65W
LED Pcs	16	20	28	36	58
Luminous Flux	1980Lm	2750Lm	3850Lm	4950Lm	7150Lm
Power Factor	>0.95				
Light Source	LED				
Input Voltage Frequency	AC100 - 277 V 50/60HZ				
Colour Temperature	4000 ± 300k / 5000 ± 300k / 5700 ± 300k				
Colour Rendering Index	Ra > 70				
Light Distribution	C0 / 180° : 145 °, C90 / 270 ° : 85 °				
Operating Temperature	- 40 °C ~ 45 °C				
Operating Humidity	10% ~ 90% HD				
Lifetime Residual Flux	50,000 Hrs				
Housing	Marine Grade Aluminium				
IP Rating	IP66				
Dimensions	514 x 514 x 680 mm				
Class	Class I & II Optional				
Surge Arrestor	10Kv				



MAGNITECH - benchmarking
the standard of **QUALITY**

Head Office: +27 (11) 618 2720 | Fax: +27 (11) 614 9603,
5 Raebor Road Benrose Johannesburg 2094,
P.O. Box 27129 Jeppeshtown 2043



Due to our continuing R&D, the data featured in this brochure may change without prior notice. Warranties are subject to our standard terms and conditions of sale. Contact our experienced technical sales team for additional information on our full range of products as well as options and accessories available.